



IDEAL TUBOS e conexões



Lider em Aço



Catálogo

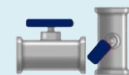

Cotovelo 45° Fêmea / Fêmea BSP 150 libras



Medida (Pol.)	Diâmetro Nom.
1/2"	15
3/4"	20
1"	25
1.1/4"	32
1.1/2"	40
2"	50
2.1/2"	65
3"	80
4"	100

Cotovelo 90° Fêmea / Fêmea BSP 150 libras



Medida (Pol.)	Diâmetro Nom.
1/4"	8
3/8"	10
1/2"	15
3/4"	20
1"	25
1.1/4"	32
1.1/2"	40
2"	50
2.1/2"	65
3"	80
4"	100

Cotovelo 90° Macho / Fêmea BSP 150 libras



Medida (Pol.)	Diâmetro Nom.
1/2"	15
3/4"	20
1"	25
1.1/4"	32
1.1/2"	40
2"	50
2.1/2"	65

Cotovelo de Redução BSP 150 libras



Medida (Pol.)	Diâmetro Nom.
3/4" x 1/2"	20x15
1" x 1/2"	20x15
1" x 3/4"	25x20
1.1/4" x 1/2"	32x15
1.1/4" x 3/4"	32x20
1.1/4" x 1"	32x25
1.1/2" x 3/4"	40x20
1.1/2" x 1"	40x25
1.1/2" x 1.1/4"	40x32
2" x 1.1/2"	50x40

Tee – Fêmea / Fêmea / Fêmea BSP 150 libras



Medida (Pol.)	Diâmetro Nom.
1/4"	8
3/8"	10
1/2"	15
3/4"	20
1"	25
1.1/4"	32
1.1/2"	40
2"	50
2.1/2"	65
3"	80
4"	100

Tês de Redução BSP 150 libras



Medida (Pol.)	Diâmetro Nom.
1/2 x 1/4	15 x 8
1/2 x 3/8	15 x 10
3/4 x 3/8	20 x 10
3/4 x 1/4	20 x 8
3/4 x 1/2	20 x 15
1 x 1/2	25 x 15
1 x 3/4	25 x 20
1.1/4 x 1/2	32 x 15
1.1/4 x 3/4	32 x 20
1.1/4 x 1	32 x 25
1.1/2 x 1/2	40 x 15
1.1/2 x 3/4	40 x 20
1.1/2 x 1	40 x 25

Medida (Pol.)	Diâmetro Nom.
1.1/2 x 1.1/4	40 x 32
2 x 1/2	50 x 15
2 x 3/4	50 x 20
2 x 1	50 x 25
2 x 1.1/4	50 x 32
2 x 1.1/2	50 x 40
2.1/2 x 1/2	65 x 15
2.1/2 x 3/4	65 x 20
2.1/2 x 1	65 x 25
2.1/2 x 1.1/4	65 x 32
2.1/2 x 1.1/2	65 x 40
2.1/2 x 2	65 x 50
3 x 1.1/4	80 x 32

Tee 45° – Fêmea / Fêmea / Fêmea BSP 150 libras



Medida (Pol.)	Diâmetro Nom.
1/2"	15
3/4"	20
1"	25
1.1/4"	32
1.1/2"	40
2"	50
2.1/2"	65
3"	80
4"	100

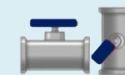
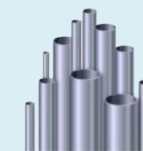

Flange Sextavado BSP 150 libras



Medida (Pol.)	Diâmetro Nom.
1/2"	15
3/4"	20
1"	25
1.1/4"	32
1.1/2"	40
2"	50
2.1/2"	65
3"	80
4"	100

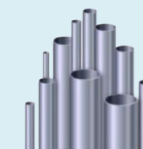

Curva Fêmea / Fêmea 90° BSP 150 libras

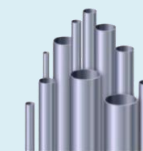

Curva Macho / Fêmea 90° BSP 150 libras



Medida (Pol.)	Diâmetro Nom.
1/2"	15
3/4"	20
1"	25
1.1/4"	32
1.1/2"	40
2"	50
2.1/2"	65
3"	80
4"	100

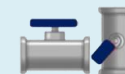

Curva Macho / Macho 90° BSP 150 libras

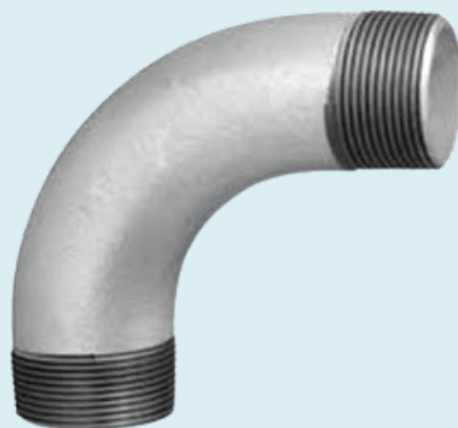

Medida (Pol.)	Diâmetro Nom.
1/2"	15
3/4"	20
1"	25
1.1/4"	32
1.1/2"	40
2"	50
2.1/2"	65
3"	80
4"	100

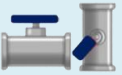

Curva Fêmea / Fêmea 45° BSP 150 libras

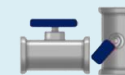
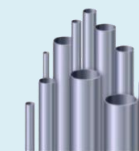

Curva Macho / Fêmea 45° BSP 150 libras



Medida (Pol.)	Diâmetro Nom.
1/2"	15
3/4"	20
1"	25
1.1/4"	32
1.1/2"	40
2"	50
2.1/2"	65
3"	80
4"	100

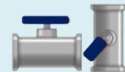

Luva Paralela Fêmea / Fêmea BSP 150 libras



Medida (Pol.)	Diâmetro Nom.
1/4"	8
3/8"	10
1/2"	15
3/4"	20
1"	25
1.1/4"	32
1.1/2"	40
2"	50
2.1/2"	65
3"	80
4"	100

Luva de Redução Fêmea / Fêmea BSP 150 libras



Medida (Pol.)	Diâmetro Nom.
1/2 x 1/4	15 x 8
1/2 x 3/8	15 x 10
3/4 x 3/8	20 x 10
3/4 x 1/4	20 x 8
3/4 x 1/2	20 x 15
1 x 1/2	25 x 15
1 x 3/4	25 x 20
1.1/4 x 1/2	32 x 15
1.1/4 x 3/4	32 x 20
1.1/4 x 1	32 x 25
1.1/2 x 1/2	40 x 15
1.1/2 x 3/4	40 x 20
1.1/2 x 1	40 x 25

Medida (Pol.)	Diâmetro Nom.
1.1/2 x 1.1/4	40 x 32
2 x 1/2	50 x 15
2 x 3/4	50 x 20
2 x 1	50 x 25
2 x 1.1/4	50 x 32
2 x 1.1/2	50 x 40
2.1/2 x 1/2	65 x 15
2.1/2 x 1	65 x 25
2.1/2 x 1.1/4	65 x 32
2.1/2 x 1.1/2	65 x 40
2.1/2 x 2	65 x 50

Bucha de Redução Macho / Fêmea BSP 150 libras



Medida (Pol.)	Diâmetro Nom.
3/8 x 1/4	10 x 8
1/2 x 1/4	15 x 8
1/2 x 3/8	15 x 10
3/4 x 3/8	20 x 10
3/4 x 1/4	20 x 8
3/4 x 1/2	20 x 15
1 x 1/2	25 x 15
1 x 3/4	25 x 20
1.1/4 x 1/2	32 x 15
1.1/4 x 3/4	32 x 20
1.1/4 x 1	32 x 25
1.1/2 x 1/2	40 x 15
1.1/2 x 3/4	40 x 20
1.1/2 x 1	40 x 25

Medida (Pol.)	Diâmetro Nom.
1.1/2 x 1.1/4	40 x 32
2 x 1/2	50 x 15
2 x 3/4	50 x 20
2 x 1	50 x 25
2 x 1.1/4	50 x 32
2 x 1.1/2	50 x 40
2.1/2 x 1/2	65 x 15
2.1/2 x 1	65 x 25
2.1/2 x 1.1/4	65 x 32
2.1/2 x 1.1/2	65 x 40
2.1/2 x 2	65 x 50
3 x 1	80 x 25
3 x 1.1/4	80 x 32
3 x 1.1/2	80 x 40



Niples Duplos BSP 150 libras



Medida (Pol.)	Diâmetro Nom.
1/4"	8
3/8"	10
1/2"	15
3/4"	20
1"	25
1.1/4"	32
1.1/2"	40
2"	50
2.1/2"	65
3"	80
4"	100

Nipples Duplos de Redução BSP 150 libras



Medida (Pol.)	Diâmetro Nom.
3/8 x 1/4	10 x 8
1/2 x 1/4	15 x 8
1/2 x 3/8	15 x 8
3/4 x 1/2	20 x 15
1 x 1/2	20 x 15
1 x 3/4	25 x 20
1.1/4 x 1/2	32 x 15
1.1/4 x 1	32 x 20
1.1/2 x 1/2	40 x 15
1.1/2 x 3/4	40 x 20
1.1/2 x 1	40 x 25

Medida (Pol.)	Diâmetro Nom.
1.1/2 x 1.1/4	40 x 32
2 x 1/2	50 x 15
2 x 3/4	50 x 20
2 x 1.1/2	50 x 32
2.1/2 x 1	65 x 25
2.1/2 x 1.1/2	65 x 40
3 x 2	80 x 50
3 x 2.1/2	100 x 80
4 x 3	100 x 80

Bujão Macho (Plug) BSP 150 libras



Medida (Pol.)	Diâmetro Nom.
1/4"	8
3/8"	10
1/2"	15
3/4"	20
1"	25
1.1/4"	32
1.1/2"	40
2"	50
2.1/2"	65
3"	80
4"	100

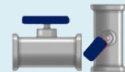

Tampão Fêmea (Cap) BSP 150 libras



Medida (Pol.)	Diâmetro Nom.
1/4"	8
3/8"	10
1/2"	15
3/4"	20
1"	25
1.1/4"	32
1.1/2"	40
2"	50
2.1/2"	65
3"	80
4"	100

Uniões de Assento Bronze – Fêmea / Fêmea BSP

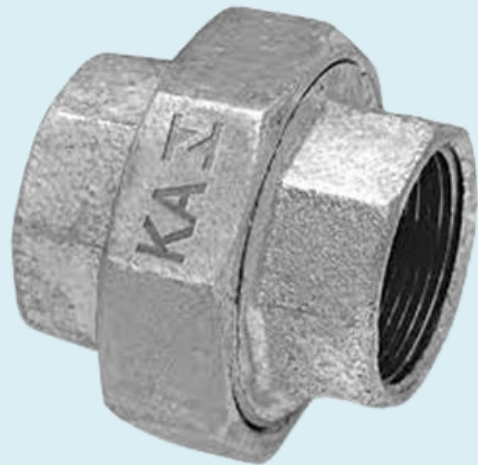

Medida (Pol.)	Diâmetro Nom.
1/4"	8
3/8"	10
1/2"	15
3/4"	20
1"	25
1.1/4"	32
1.1/2"	40
2"	50
2.1/2"	65
3"	80
4"	100

Uniões de Assento Ferro – Fêmea / Fêmea BSP



Medida (Pol.)	Diâmetro Nom.
1/4"	8
3/8"	10
1/2"	15
3/4"	20
1"	25
1.1/4"	32
1.1/2"	40
2"	50
2.1/2"	65
3"	80
4"	100